

## Getting to the University of Surrey School of Veterinary Medicine

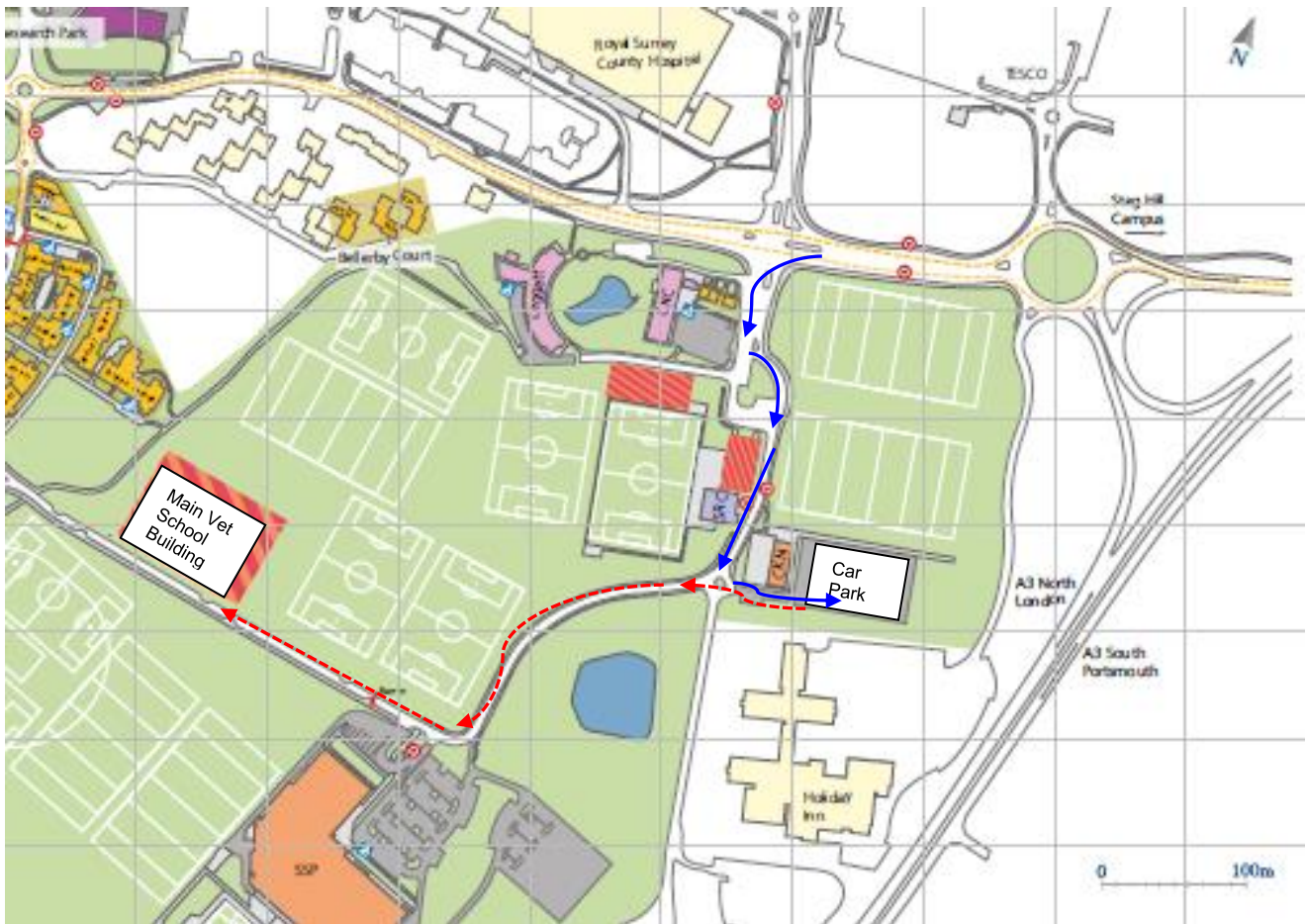

The University of Surrey is based in Guildford, in the South East of England; situated close to the Guildford mainline train station and within a short walk of the town centre. The Manor Park Campus which includes Surrey Sports Park and the School of Veterinary Medicine is located a few minutes drive across the A3 from the University's main Stag Hill Campus, near the Royal Surrey County Hospital.

### By Car

Guildford is 30 miles south-west of London, on the A3 London-Portsmouth road. If approaching from London or the M25 (Junction 10), remain on the bypass (A3) until you reach the exit signed to the Cathedral and University. At the roundabout take the third exit signposted Royal Surrey County Hospital and University, Manor Park. Continue under the A3 and straight across the next roundabout into Gill Avenue. Turn left at the traffic lights onto Richard Meyjes Road, then after approximately 250m take the sharp turning left into the Car Park by the University Creche.

If you are using sat nav please enter the postcode GU2 7AD which should bring you onto Richard Meyjes Road.

KEY:  Driving Route to car park  Walking Route to Vet School (c 400m)