

EVENING LANGUAGE COURSES

AC BUILDING

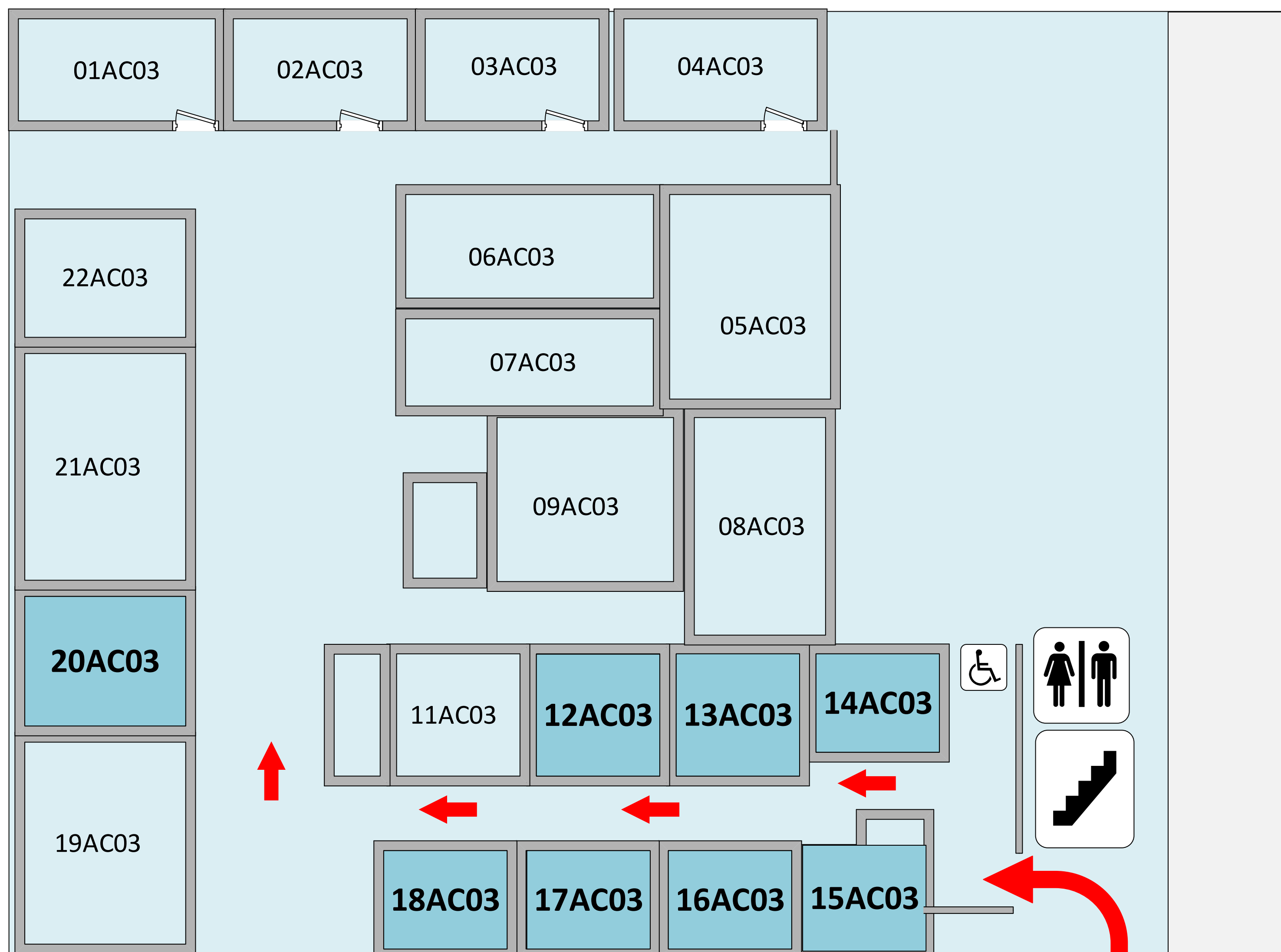

AC BUILDING (AC03)

How do I get to the AC03 rooms?

The AC building is in front of the Library and Learning Centre Building.

Exit the LC building next to the Appleseed bookshop. Opposite you will see the entrance. Enter the AC building and turn left.

LIBRARY & LEARNING CENTRE

LIBRARY & LEARNING CENTRE GROUND FLOOR (LC BUILDING)

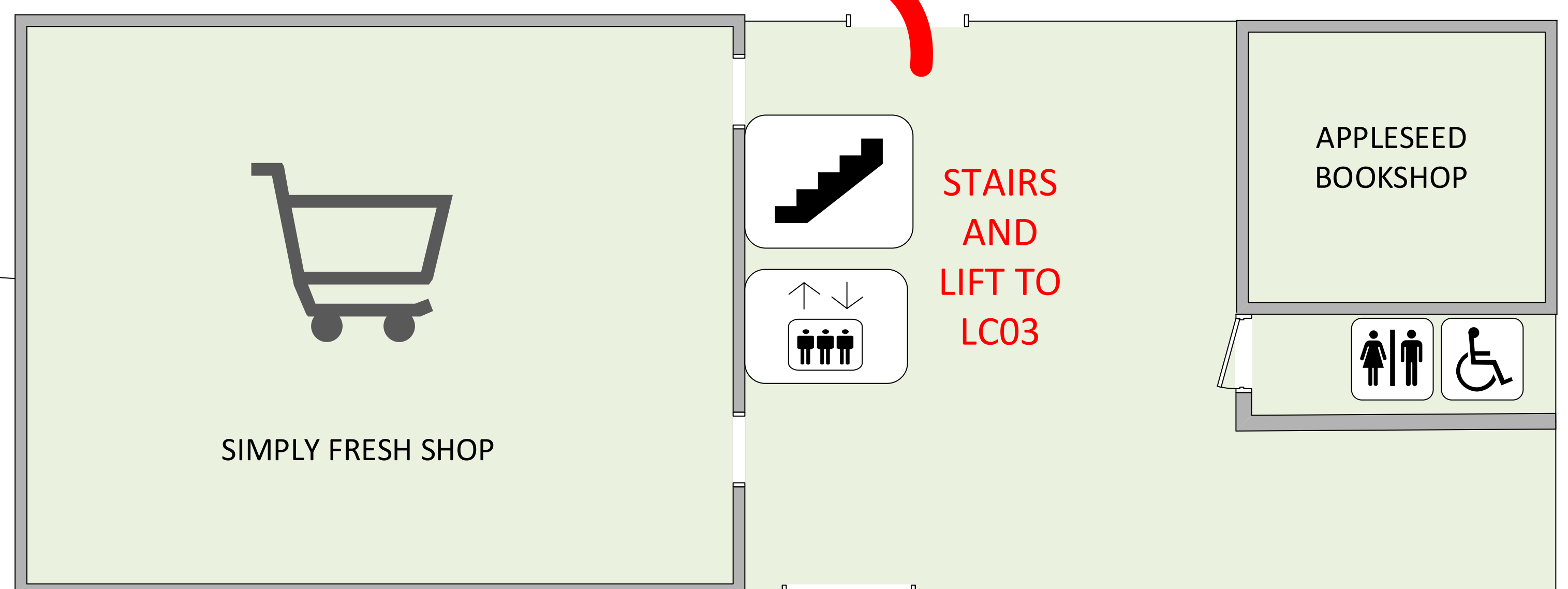

PLEASE NOTE:

Access to the AC building is restricted from 8pm.

After 8pm, you will be able to exit, but you will **not** be able to enter.

If you arrive after 8pm, please contact Security for access (level 1 of the library).

IN CASE OF EMERGENCY

There are Security guards based on Level 1 of the Library and Learning Centre 24/7.